

W-Series Front Flange Mount Crane and Mill Buffers

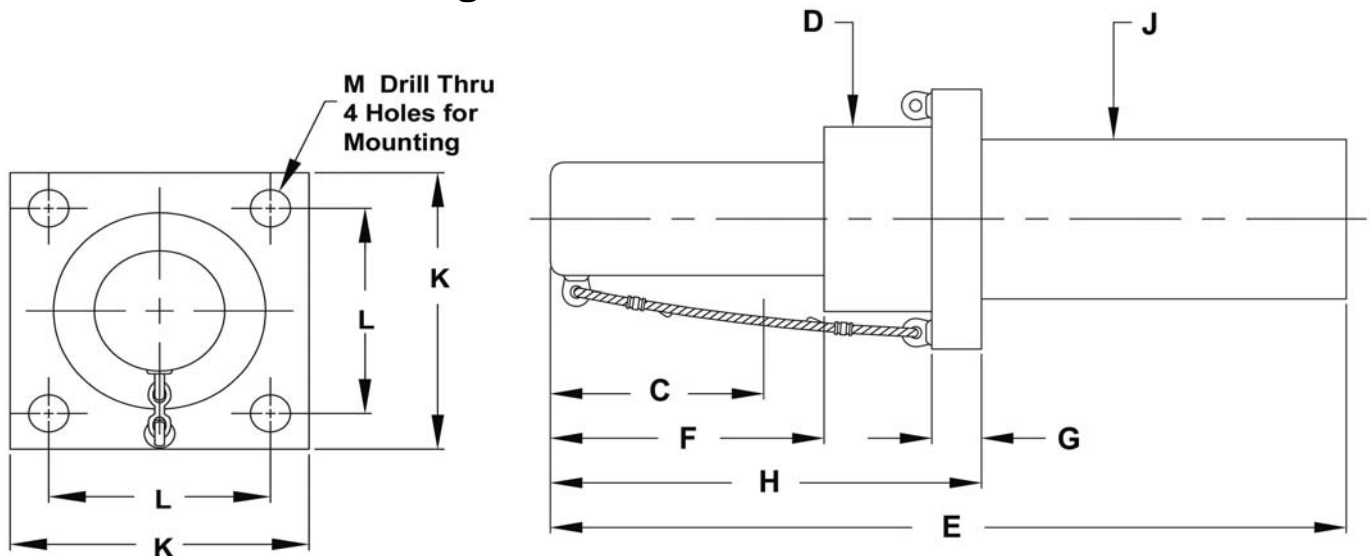

A	B	C	D	E	F	G	H	J	K	L	M	
Model	Mounting Strength Required (lbs.)	Stroke (in.)	Inches	Inches	Inches	Inches	Inches	Inches	Inches	Inches	Inches	Weight (lbs.)
1-1/2 x 3 W	9,000	3	2	13-1/8	4-7/16	1/2	6-11/16	1-5/8	4	2-3/4	9/16	10
2 x 3 W	15,000	3	2-7/8	13-1/8	4-1/2	1/2	7	2-3/8	5	3-1/2	13/16	15
2-1/2 x 3 W	22,000	3	3-1/4	13-7/8	5	3/4	8	2-11/16	6	4	13/16	25
3 x 4 W	35,000	4	4	17-7/8	6-1/2	3/4	10	3-3/8	6-1/2	4-3/8	13/16	35
4 x 6 W	60,000	6	5-1/2	24	8-1/4	1-1/2	13	4-3/4	7-3/4	5-3/4	15/16	90
5 x 8 W	85,000	8	6-1/2	33	11	1-1/2	16	5-1/2	9-1/2	7	15/16	150
6 x 8 W	165,000	8	8-1/2	35-1/8	12-7/8	2	19-5/8	7-1/16	12	9	1-1/16	250
6 x 14 W	165,000	14	8-1/2	53-1/8	18-7/8	2	25-5/8	7-1/16	12	9	1-1/16	325
7 x 10 W	225,000	10	9-1/2	43-1/8	16-1/8	2	23-5/8	8-1/8	15	10	1-5/8	400
7 x 16 W	225,000	16	9-1/2	60-1/8	22-1/8	2	29-5/8	8-1/8	15	10	1-5/8	535

Application / Design Features:

- External dimensions are as shown for all W-Series and WM-Series Crane Buffers.
- All buffers include full drive down package for use of buffer stroke as crane approaches.
- All buffers are rated for -40 degrees F to +160 degrees F continuous duty.
- Protective rubber bellows also available as an option for foundry or melt shop service, or where severe dirt or ice is present.
- Wire rope safety cables are included on all sizes to meet OSHA requirements for overhead cranes. This feature may be omitted by request.
- No maintenance, refilling, or adjusting required. The buffer will automatically adjust itself to absorb any impact within its capacity diagram.
- Solid stainless steel piston rod, hard chrome-plated cylinder, and painted mounting standard on all models. All models have one-piece cylinders machined from billet stock.